



# nakheel®

Nakheel Developments is a forward-thinking real estate company built on more than 15 years of proven success in the United Arab Emirates. The company established, completed, and managed over 20 high-quality residential compounds and luxury projects in the UAE, including Al Mehery Compound, Al Mansoury Compound, Al Zaabi Compound, Al Mashghoni Compound, Al Marzouky Compound, and Al Ahbaby Compound. With this strong foundation, Nakheel Developments expanded into Egypt, one of the region's most active and fast-growing real estate markets, delivering milestone projects such as Trio V Tower and Double Two Tower in The New Administrative Capital; mixed-use destinations designed to deliver smart, efficient, and future-ready environments. Today, Nakheel Developments continues to grow with a long-term vision driven by innovation, sustainability, and international expertise.



# **TRIO V** TOWER

Trio V Tower is a mixed-use destination consisting of a ground + 14 typical Floors bringing together administrative, commercial, and medical spaces within a modern vertical complex, overlooking the most iconic landmarks of the New Administrative Capital.

Strategically positioned at the center of the Downtown District (Mu19), Trio V offers a dynamic business and lifestyle environment crafted for functionality, visibility, and long-term value.

The name Trio V is inspired by the project's strongest advantage, its exceptional visibility. "Trio" represents the tower's three prime view corridors, while "V" signifies the panoramic views that define the development. Positioned on a unique corner footprint, Trio V offers direct views of the Central Park, sweeping panoramas of the Green River, and a wide main street frontage spanning 70 to 80 meters. This rare visual access enhances the overall experience and creates a seamless and elevated environment for businesses and visitors.



 **TRIO V**  
TOWER

# THE HEART OF THE CITY

Close to all the main facilities of Egypt's new Administrative City

2 minutes from the Government and Ministries District

4 minutes from BEN ZAYED AXIS

5 minutes from EL MASA HOTEL

20 minutes from The New Capital Airport

20 minutes from New Cairo

 **LOCATION**

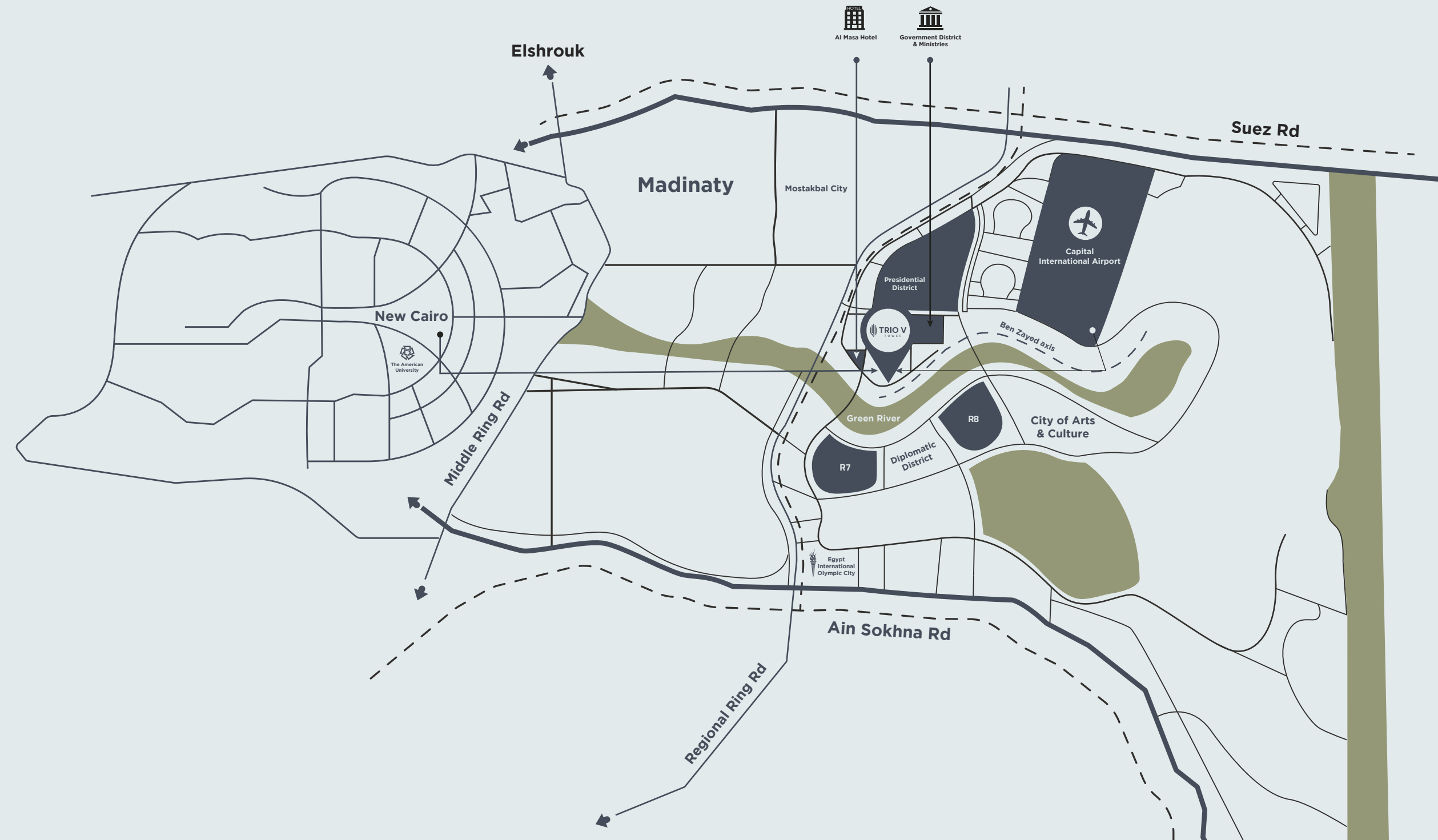

**The project was called Trio v for its Prime location at the heart of the Downtown with three main facades**

- Direct view over The Central Park of the Downtown
- Direct views of The Green River
- Main Street View exposed to 70 M
- A wide street view 40 M

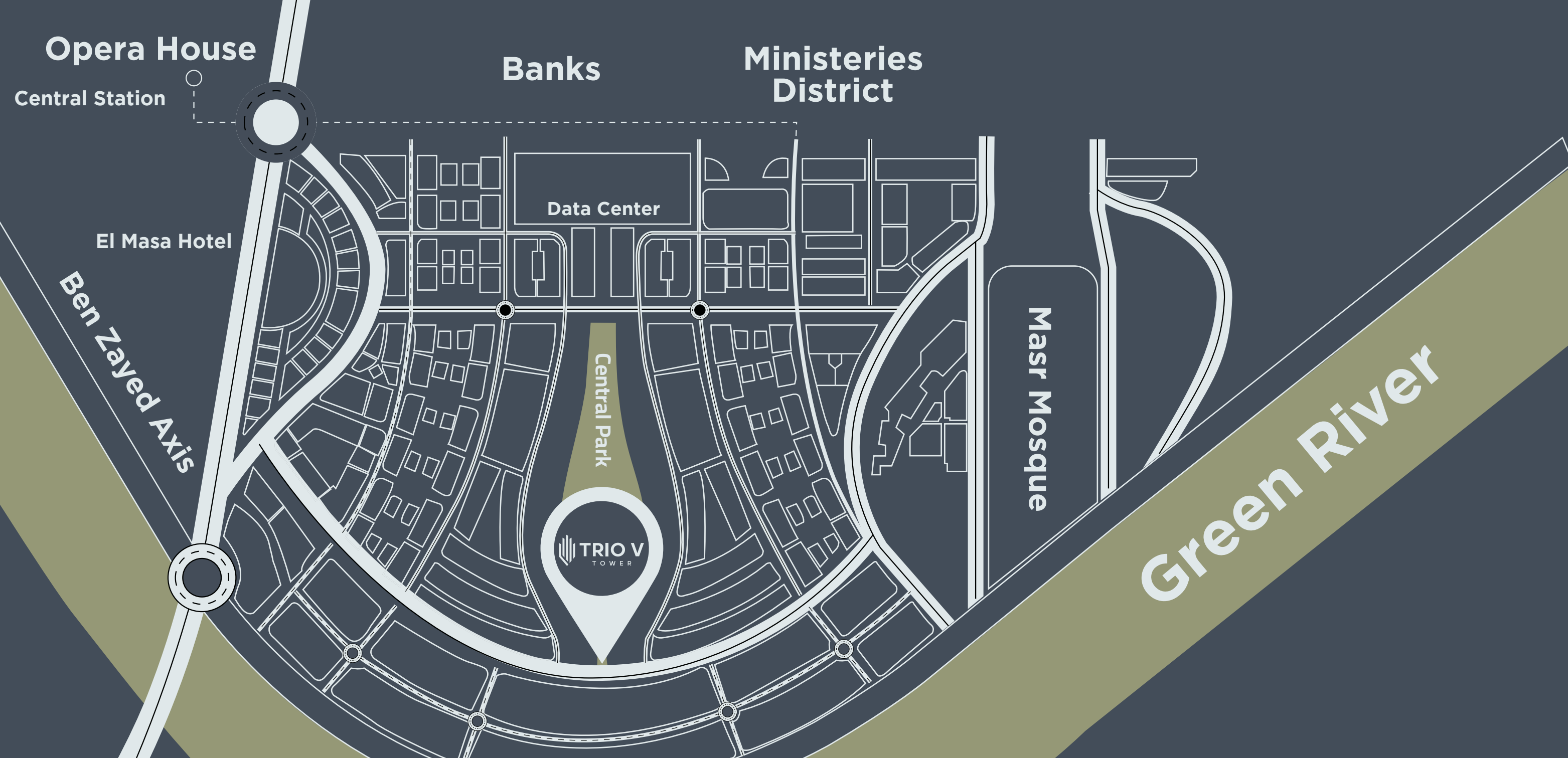

# DESIGN AND MASTER PLAN

## **Total Number Of Floors**

Ground floors + 14 typical

## **Commercial Units**

Ground Floor - First Floor - Second Floor - Third Floor - Fourth Floor

## **Admin Units**

Fifth Floor till Fourteenth Floor

## **Admin and medical**

Eighth Floor - Ninth Floor - Tenth Floor

Trio V Tower is designed to deliver a streamlined environment enriched with smart functionality and aesthetic balance. The tower presents a clean and modern facade, layered with panoramic glazing and thoughtfully planned circulation paths. Inside, the complex offers fully integrated services supported by world-class amenities to create a vibrant environment for all practices.

Trio V Tower is thoughtfully designed to connect people with the building through smart, innovative solutions. Spanning 7,000 sqm, it combines commercial, administrative, and medical spaces. The ground to fourth floors house premium commercial units, while the upper levels offer flexible offices and specialized medical facilities. The tower also features three elegant plazas, creating vibrant open spaces for tenants and visitors.

# EXTERIOR





 **TRIO V**  
TOWER



 **TRIO V**  
TOWER



 **TRIO V**  
TOWER

# INTERIOR









# FACILITIES





**Car care**

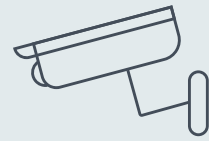

**CCTV**



**Bikes parking**



**Equipped emergency slots**

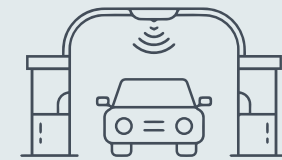

**Electronic parking gates**



**Smart parking system**

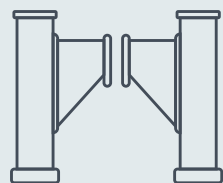

**Separated entrance**



**meeting room**

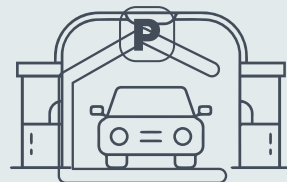

**3 basement floors parking**

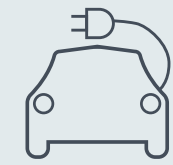

**Electric car charging**



**Basement**



**Special need facilities**



**Solar power**

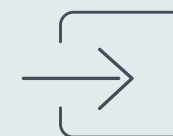

**Direct access from parking to the plaza**

# AMENITIES



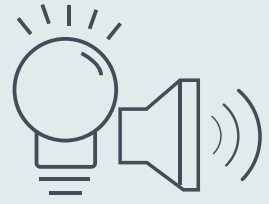

**Sound &  
Light Smart System**



**Food Court**

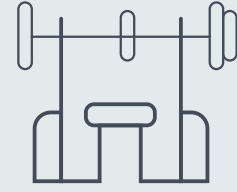

**Gym**

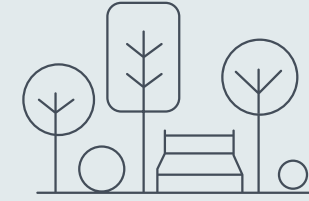

**Public Utilities**

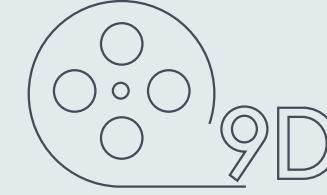

**9D Cinema**



**Laundry**



**Fresh Food Market**



**Plazas, & Sky Plaza**



**VR Station**



**Kids' Area**

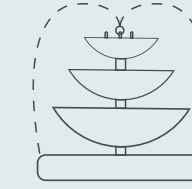

**Water Features**

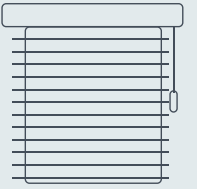

**Air Curtains**



**Mini Mart Area**



**Lockers**

# FLOOR PLANS



# GROUND FLOOR

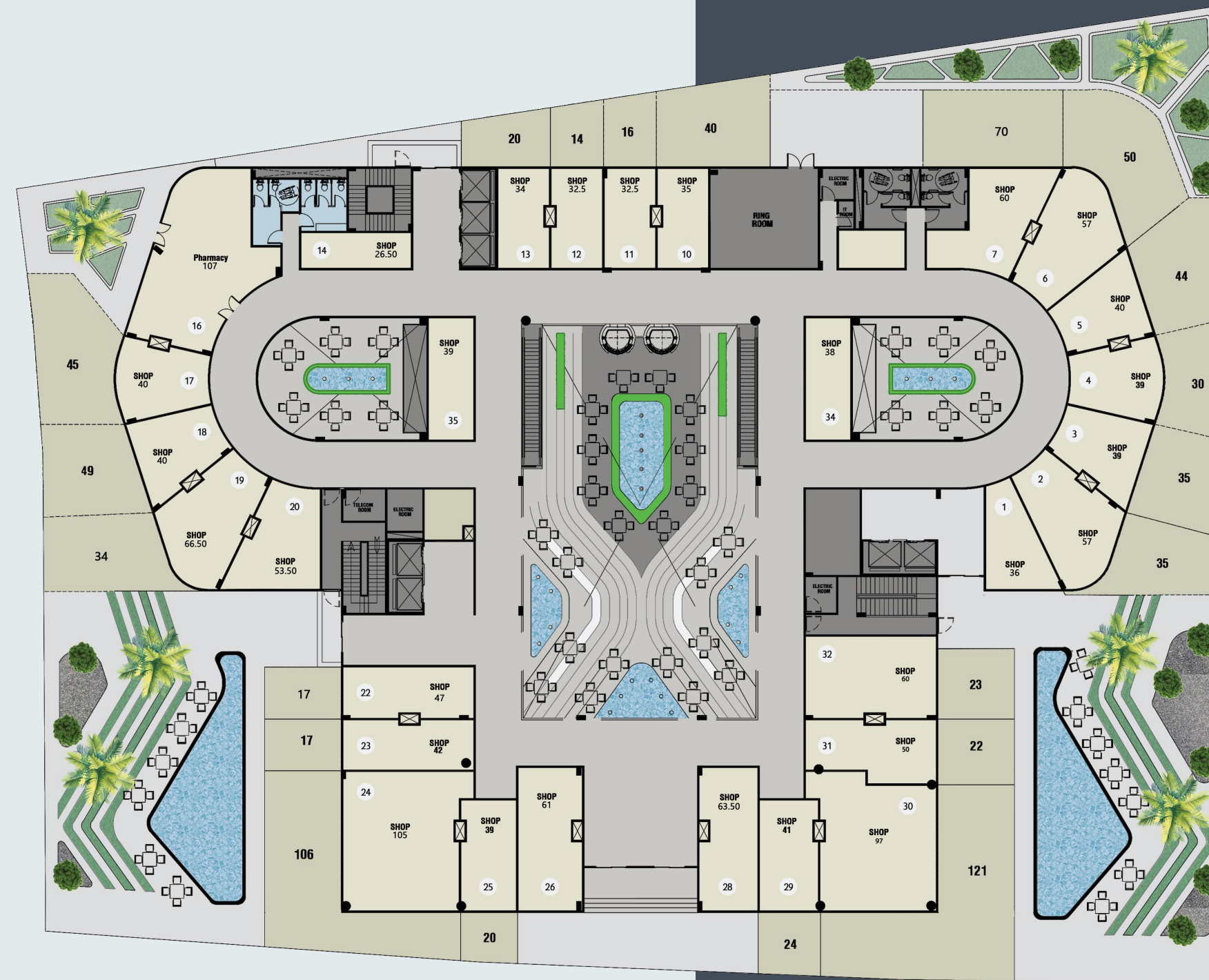





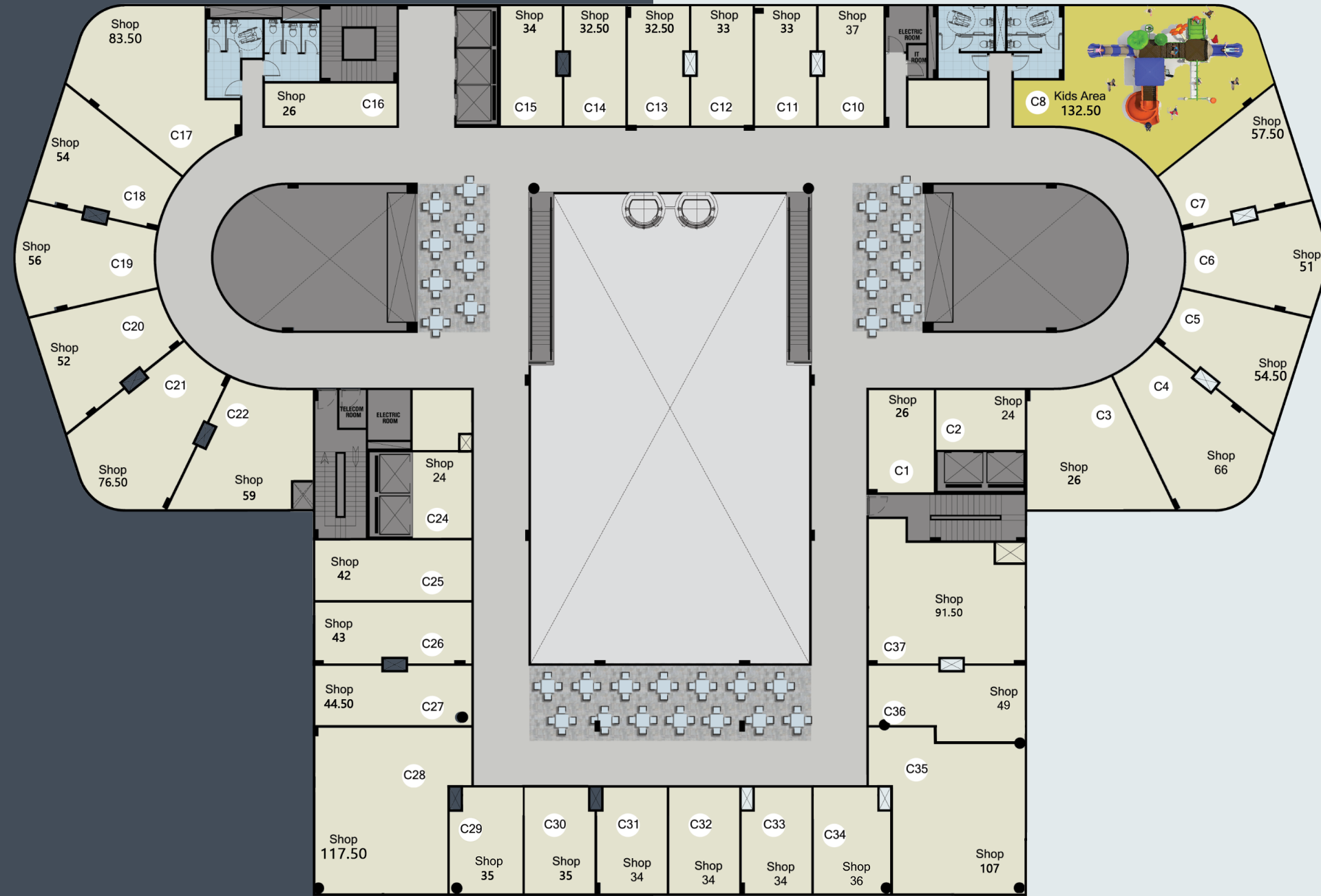

# THIRD FLOOR

# FOURTH FLOOR



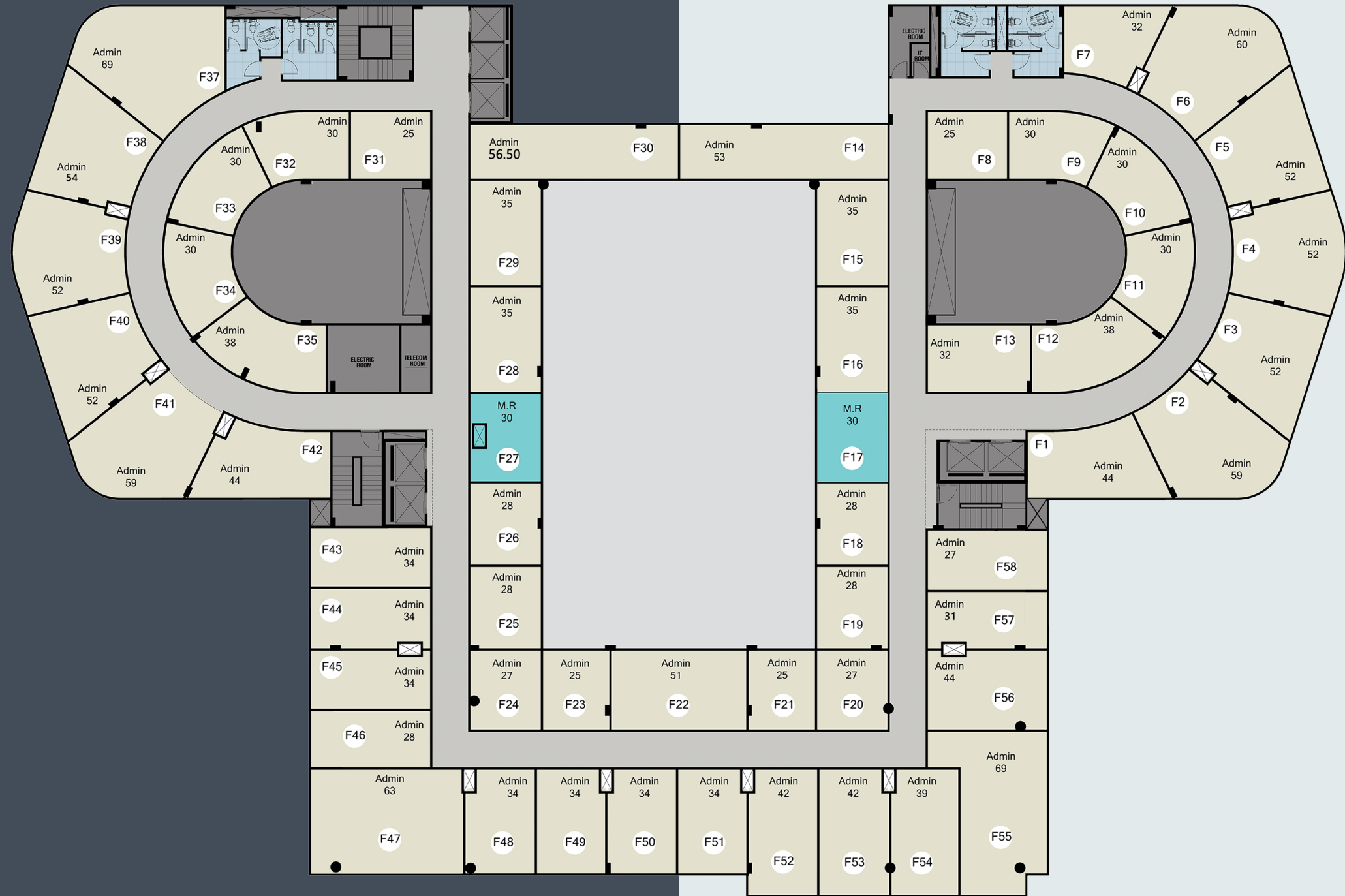

# SIXTH FLOOR

# EIGHTH FLOOR





# NINTH FLOOR

# TENTH FLOOR





# ELEVENTH FLOOR

# TWELFTH FLOOR





# THIRTEENTH FLOOR

# FOURTEENTH FLOOR



# OUR PARTNERS



ACE PROJECT MANAGEMENT  
MOHARRAM BAKHOUM

**MRB**

# GET IN TOUCH

Building 332, S.90<sup>th</sup> Street, New Cairo

[info@nakheeldevelopments.com](mailto:info@nakheeldevelopments.com)



15408

[www.nakheeldevelopments.com](http://www.nakheeldevelopments.com)